

06.C

ETAJ I

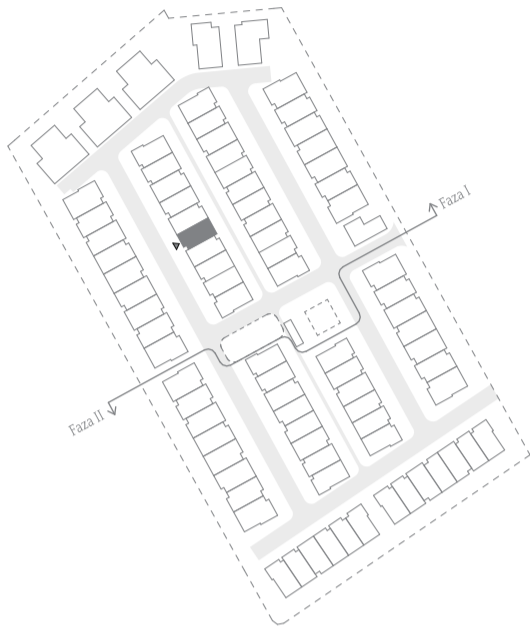

SUPRAFETE UTILE MODUL 06C

HOL CASA SCARII	9.79 m ²
LIVING + DINING	28.86 m ²
BUCATARIE	8.12 m ²
BAIE	4.71 m ²
SPATIU TEHNIC	3.79 m ²
HOL ACCES	4.96 m ²
SPALATORIE + DEPOZITARE	3.74 m ²
TOTAL	63.97 m²

BAIE	3.88 m ²
BAIE MATRIMONIALA	5.30 m ²
DORMITOR	14.64 m ²
DORMITOR	15.22 m ²
DORMITOR MATRIMONIAL	19.45 m ²
DRESSING	1.80 m ²
DRESSING	3.88 m ²
HOL CASA SCARII	4.16 m ²
TOTAL	68.33 m²

BAIE	5.35 m ²
OPEN SPACE	25.82 m ²
TOTAL	31.17 m²

*Suprafata glafuri ferestre 4.37 m²

SUPRAFETE EXTERIOARE 06C

TERASA	37.04 m ²
PARCARE	13.96 m ²
PARCARE	10.69 m ²
CURTE	31.06 m ²
TOTAL	92.74 m²

Suprafata utila	167.84 m ²
Suprafata construita	210.22 m ²
Suprafata TEREN	158.01 m ²

