

12.B

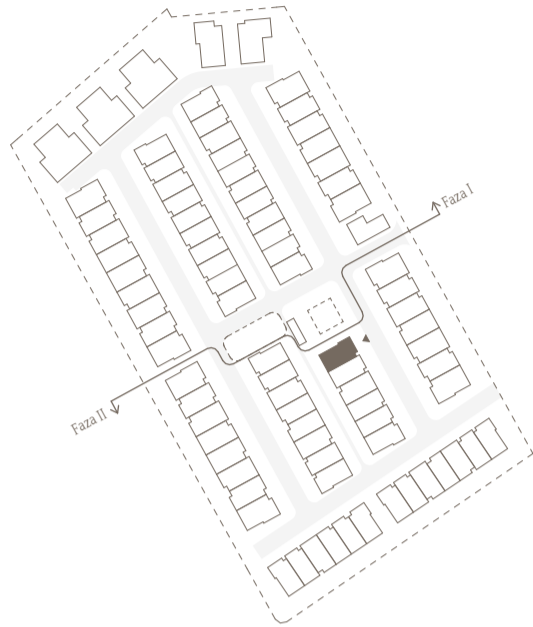

SUPRAFETE UTILE MODUL 12B

LIVING + DINING	30.82 m ²
BUCATARIE	8.56 m ²
DEPOZITARE + SPALATORIE	5.40 m ²
BAIE	4.82 m ²
SPATIU TEHNIC	3.60 m ²
HOL ACCES	5.56 m ²
SCARA	10.40 m ²
TOTAL	69.17 m ²

DORMITOR MATRIMONIAL	22.72 m ²
BAIE MATRIMONIALA	4.88 m ²
BAIE	4.52 m ²
DORMITOR	14.11 m ²
DORMITOR	17.81 m ²
HOL	5.42 m ²
DRESSING	1.84 m ²
TOTAL	71.31 m ²

OPEN SPACE	41.09 m ²
BAIE	4.00 m ²
TOTAL	45.09 m ²

*Suprafata glafuri ferestre 4.83 m²

SUPRAFETE EXTERIOARE 12B

PARCARE	16.20 m ²
PARCARE	11.28 m ²
CURTE	57.45 m ²
TERASA	27.91 m ²
BALCON	1.67 m ²
TOTAL	114.51 m ²

Suprafata utila	190.40 m ²
Suprafata construita	241.78 m ²
Suprafata TEREN	212.13 m ²

